

Schlüter®-Systems

Supplementary Price List Autumn 2022

United Kingdom · Effective 1st October 2022

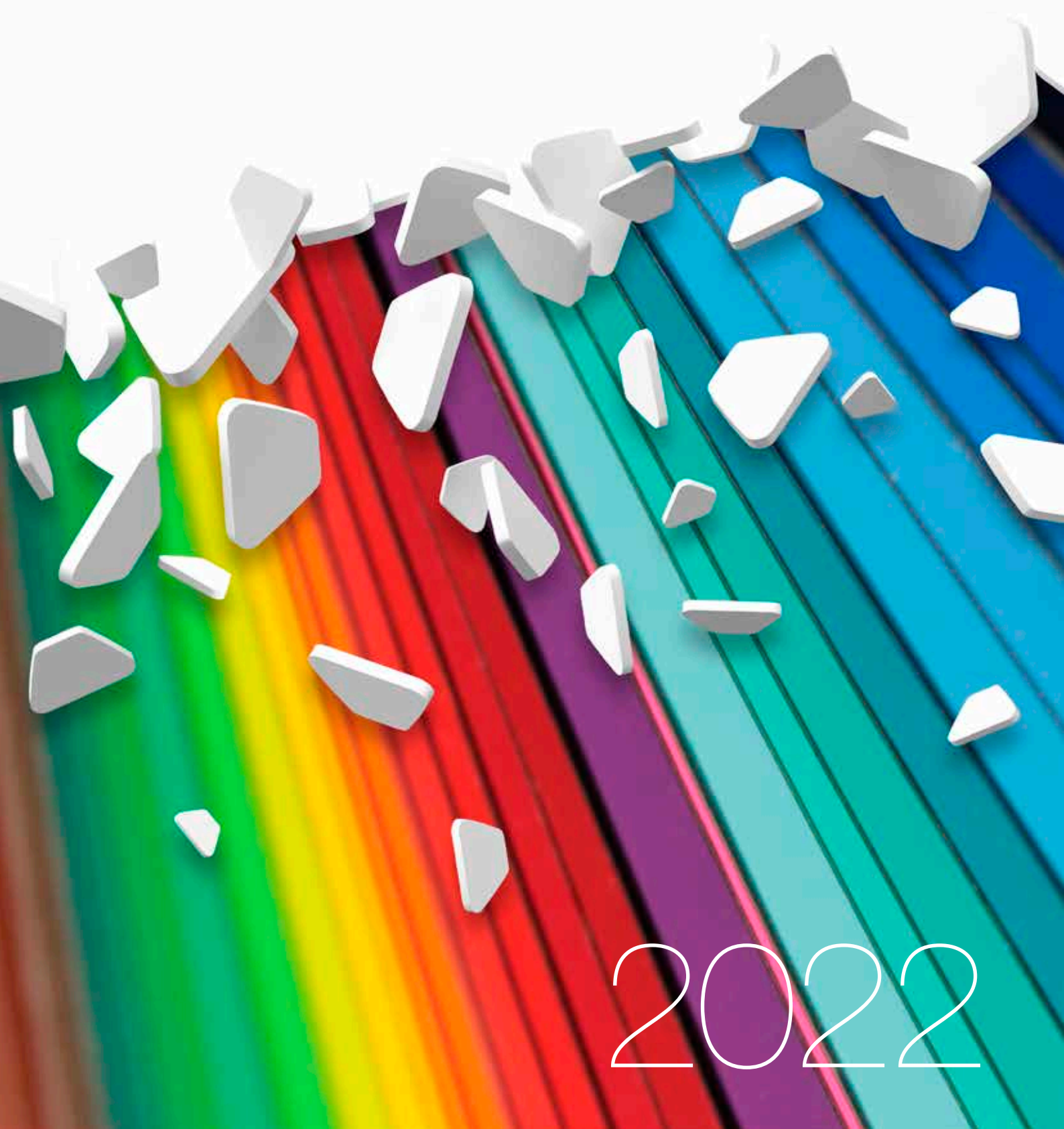

2022



MyDesign by Schlüter-Systems

Profiles and SHELF in your exclusive colour selection

Schlüter-Systems offers its customers a wide range of colour coatings for aluminium profiles. These choices were recently expanded by the addition of the Schlüter-TRENDLINE programme, which comprises especially nuanced colour variants. In most cases, this enables unobtrusive edge protection solutions in colours matching the tile covering.

However, designers or developers sometimes have special colour requests that fall outside of the available Schlüter standard colour range. For instance, the corporate design guidelines of a company may specify certain colours or developers may have unusual colour schemes in mind.

Those custom colour preferences can now be implemented with MyDesign by Schlüter-Systems! Effective immediately, a wide range of products is available in individual colour choices, in addition to our extensive colour palette of TRENDLINE and powder coating options. Customers can now choose from an impressive 190 hues of the RAL classic colour chart.

The following pages explain which profiles are available with custom coatings and how you can order them. The product advisors of our sales service and our Customer Service Department will be pleased to assist you with any questions you may have about MyDesign by Schlüter-Systems. You can easily find the respective contact information on our website. We look forward to helping you with your Schlüter MyDesign projects.



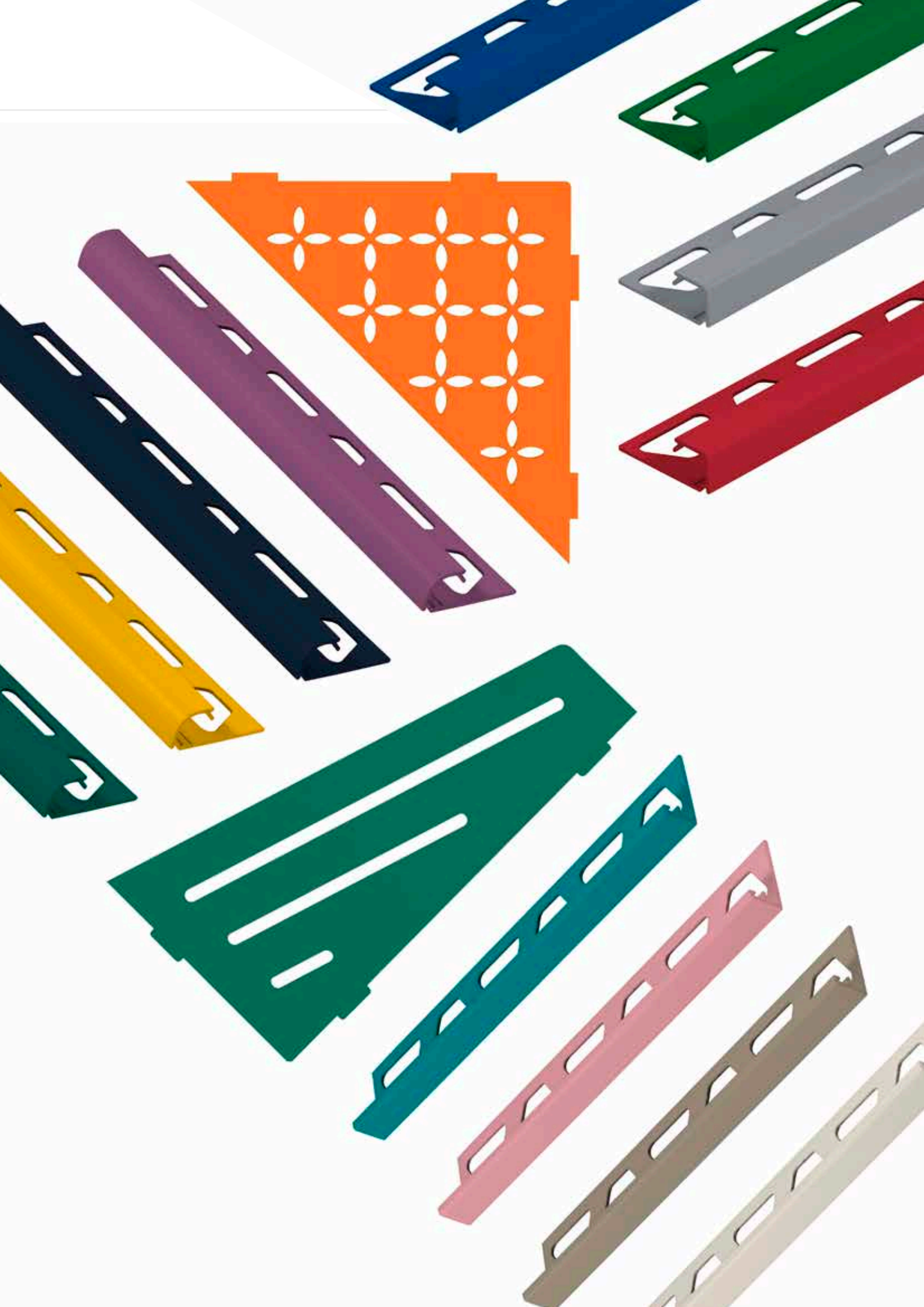

MyDesign by Schlüter-Systems

Easy custom orders

The following pages explain which products can be ordered in RAL colours for MyDesign by Schlüter-Systems. Please note that custom coatings are subject to a one-time MyDesign surcharge for each colour. You can then have any number of profiles, accessories and SHELF products from the MyDesign programme coated in this colour. The MyDesign surcharge is £ 323.75 per colour.

Simply follow the four steps in the "Price" section to determine the cost of your custom-coated MyDesign products.

Order

Find the right order number in three steps:

- | | |
|---|-------------------------------|
| 1. Select the product from the MyDesign programme | e.g. QUADec-AC (C / Q ...* A) |
| 2. Select height add to art. no. | e.g. 4.5 mm C / Q 45 A |
| 3. Select RAL Classic colour and specify it in your order | e.g. RAL 6001 |

Your sales advisor will be pleased to assist you with your order.

Price

Calculate your price in four steps:

- | | |
|--|-----------------------------------|
| 1. MyDesign surcharge (one-time set-up cost per colour) | £ 323.75 |
| 2. Select the price of the desired product (profile, corner, connector or shelf) from PS 22* | |
| 3. Add the MyDesign surcharge A B | £ 2.78 £ 5.55 per unit or metre |
| 4. If applicable, add the surcharge for radius perforation (details on page 292 of our main price list PS 22). | |

* plus 7.5% price adjustment as of 1st August 2022

Calculation help

1. SET-UP COST	2. PRODUCT	3. SURCHARGE	PRICE
<input type="text"/>	<input type="text"/>	<input type="text"/>	<input type="text"/>
<input type="text"/>	<input type="text"/>	<input type="text"/>	<input type="text"/>
<input type="text"/>	<input type="text"/>	<input type="text"/>	<input type="text"/>
<input type="text"/>	<input type="text"/>	<input type="text"/>	<input type="text"/>
<input type="text"/>	<input type="text"/>	<input type="text"/>	<input type="text"/>
<input type="text"/>	<input type="text"/>	<input type="text"/>	<input type="text"/>

FINISHING PROFILE | CORNER



Schlüter®-QUADEC-AC



colour coated aluminium
 profile length: 2.50 m/3.00 m, height: 4.5 mm, 6 mm, 8 mm, 10 mm, 11 mm, 12.5 mm
 90° external/internal corner in heights of 4.5 mm, 6 mm, 8 mm, 10 mm, 11 mm, 12.5 mm

Version	Art. No.	MyDesign surcharge
profile 2.50 m (4.5–12.5 mm)	C / Q ...* A	A
profile 3.00 m (6–12.5 mm)	C / Q ...* A/300	A
profile 2.50 m, radius perforation (4.5–12.5 mm)	C / R / Q ...* A	A
profile 3.00 m, radius perforation (6–12.5 mm)	C / R / Q ...* A/300	A
90° external/internal corner (4.5–12.5 mm)	C / EV / Q ...* A	A

* To complete the art. no., add the height (e.g. C / Q 45 A)

You can find the full Schlüter-QUADEC-AC product line on page 37 of the PS 22 price list.

FINISHING PROFILE | CORNER



Schlüter®-RONDEC-AC



colour coated aluminium
 profile length: 2.50 m/3.00 m, height: 6 mm, 8 mm, 10 mm, 11 mm, 12.5 mm
 90° external/internal corner in heights of 6 mm, 8 mm, 10 mm, 11 mm, 12.5 mm

Version	Art. No.	MyDesign surcharge
profile 2.50 m (6–12.5 mm)	C / RO ...* A	A
profile 3.00 m (6–12.5 mm)	C / RO ...* A/300	A
profile 2.50 m, radius perforation (6–12.5 mm)	C / R / RO ...* A	A
profile 3.00 m, radius perforation (6–12.5 mm)	C / R / RO ...* A/300	A
90° external corner (6–12.5 mm)	C / EV / RO ...* A	A
90° internal corner (6–12.5 mm)	C / IV / RO ...* A	A

* To complete the art. no., add the height (e.g. C / RO 60 A)

You can find the full Schlüter-RONDEC-AC product line on page 46 (profiles) and page 43 (corners) of the PS 22 price list.

FINISHING PROFILE | CORNER



Schlüter®-JOLLY-AC



colour coated aluminium
 profile length: 2.50 m/3.00 m, height: 6 mm, 8 mm, 10 mm, 11 mm, 12.5 mm
 90° external corner in heights of 6 mm, 8 mm, 10 mm, 11 mm, 12.5 mm

Version	Art. No.	MyDesign surcharge
profile 2.50 m (6–12.5 mm)	C / J ...* A	A
profile 3.00 m (6–12.5 mm)	C / J ...* A/300	A
profile 2.50 m, radius perforation (6–12.5 mm)	C / R / J ...* A	A
profile 3.00 m, radius perforation (6–12.5 mm)	C / R / J ...* A/300	A
90° external corner (6–12.5 mm)	C / EV / J ...* A	A

* To complete the art. no., add the height (e.g. C / J 60 A)

You can find the full Schlüter-JOLLY-AC product line on page 51 of the PS 22 price list.

FINISHING PROFILE | CORNER SET



Schlüter®-FINEC-AC



colour coated aluminium
profile length: 2.50 m, height: 2.5 mm, 4.5 mm, 7 mm, 9 mm, 11 mm, 12.5 mm
corner set, height: 2.5 mm, 4.5 mm, 7 mm, 9 mm, 11 mm, 12.5 mm

Version	Art. No.	MyDesign surcharge
profile 2.50 m (2.5–12.5 mm)	C / F ...* A	A
corner set (2.5–12.5 mm)	C / ES / F ...* A	A

* To complete the art. no., add the height (e.g. C / F 25 A)

You can find the full Schlüter-FINEC-A product line on page 60 of the PS 22 price list.

SKIRTING PROFILE | CORNER | END CAP | CONNECTOR



Schlüter®-DESIGNBASE-SL-AC



colour coated aluminium
profile length: 2.50 m, height: 60 mm, 80 mm
90° external/internal corner, left end cap, right end cap, connector in heights of 60 mm, 80 mm

Version	Art. No.	MyDesign surcharge
profile 2.50 m (60–80 mm)	C / DB SL ...* A	A
90° external corner (60–80 mm)	C / ED / DB SL ...* A	A
90° internal corner (60–80 mm)	C / ID / DB SL ...* A	A
end cap, left (60–80 mm)	C / EL / DB SL ...* A	A
end cap, right (60–80 mm)	C / ER / DB SL ...* A	A
connector (60–80 mm)	C / V / DB SL ...* A	A

* To complete the art. no., add the height (e.g. C / DB SL 60 A)

You can find the full Schlüter-DESIGNBASE-SL-A product line on pages 72–73 of the PS 22 price list.

SHELF



Schlüter®-SHELF-E-S1-AC



colour coated aluminium
shelf in design options FLORAL, CURVE, PURE, SQUARE, WAVE

Version	Art. No.	MyDesign surcharge
FLORAL design	C / SE S1 D5 A	B
CURVE design	C / SE S1 D6 A	B
PURE design	C / SE S1 D7 A	B
SQUARE design	C / SE S1 D3 A	B
WAVE design	C / SE S1 D10 A	B

You can find the full Schlüter-SHELF-E-S1 product line on pages 212–213 of the PS 22 price list.

SHELF



Schlüter®-SHELF-E-S2-AC



colour coated aluminium
shelf in design options FLORAL, CURVE, PURE, SQUARE, WAVE

Version	Art. No.	MyDesign surcharge
FLORAL design	C / SE S2 D5 A	B
CURVE design	C / SE S2 D6 A	B
PURE design	C / SE S2 D7 A	B
SQUARE design	C / SE S2 D3 A	B
WAVE design	C / SE S2 D10 A	B

You can find the full Schlüter-SHELF-E-S2 product line on pages 214–215 of the PS 22 price list.

SHELF



Schlüter®-SHELF-E-S3-AC



colour coated aluminium
shelf in design options FLORAL, CURVE, PURE, SQUARE, WAVE

Version	Art. No.	MyDesign surcharge
FLORAL design	C / SE S3 D5 A	B
CURVE design	C / SE S3 D6 A	B
PURE design	C / SE S3 D7 A	B
SQUARE design	C / SE S3 D3 A	B
WAVE design	C / SE S3 D10 A	B

You can find the full Schlüter-SHELF-E-S3 product line on pages 216–217 of the PS 22 price list.

SHELF



Schlüter®-SHELF-N-S1-AC



colour coated aluminium
shelf in design options FLORAL, CURVE, PURE, SQUARE, WAVE

Version	Art. No.	MyDesign surcharge
FLORAL design	C / SN S1 D5 A	B
CURVE design	C / SN S1 D6 A	B
PURE design	C / SN S1 D7 A	B
SQUARE design	C / SN S1 D3 A	B
WAVE design	C / SN S1 D10 A	B

You can find the full Schlüter-SHELF-N product line on pages 218–219 of the PS 22 price list.

SHELF



Schlüter®-SHELF-W-S1-AC



colour coated aluminium
shelf in design options FLORAL, CURVE, PURE, SQUARE, WAVE

Version	Art. No.	MyDesign surcharge
FLORAL design	C / SW S1 D5 A	B
CURVE design	C / SW S1 D6 A	B
PURE design	C / SW S1 D7 A	B
SQUARE design	C / SW S1 D3 A	B
WAVE design	C / SW S1 D10 A	B

You can find the full Schlüter-SHELF-W product line on pages 220–221 of the PS 22 price list.

EDGE SUPPORT PROFILE | CORNER | CONNECTOR



Schlüter®-BARA-RTK



colour coated aluminium
profile length: 2.50 m
90° external corner, 135° external corner, 90° internal corner, connectors

Version	Art. No.	MyDesign surcharge
profile 2.50 m	C / RTK 30 A	B
90° external corner	C / E90 / RTK 30 A	B
135° external corner	C / E135 / RTK 30 A	B
90° internal corner	C / I90 / RTK 30 A	B
connector	C / V / RT 30 A	A

You can find the full Schlüter-BARA-RTK product line on page 259 of the PS 22 price list.

EDGE SUPPORT PROFILE | CORNER | CONNECTOR



Schlüter®-BARA-RTKE



colour coated aluminium
profile length: 2.50 m, height: 10 mm, 15 mm, 18 mm, 21 mm, 23 mm
90° external corner, 135° external corner, 90° internal corner,
connectors in heights of 10 mm, 15 mm, 18 mm, 21 mm, 23 mm

Version	Art. No.	MyDesign surcharge
profile 2.50 m (10–23 mm)	C / RTKE ...* A	B
90° external corner (10–23 mm)	C / E90 / RTKE ...* A	B
135° external corner (10–23 mm)	C / E135 / RTKE ...* A	B
90° internal corner (10–23 mm)	C / I90 / RTKE ...* A	B
connector (10–23 mm)	C / V / RTKE ...* A	A

* To complete the art. no., add the height (e.g. C / RTKE 10 A)

You can find the full Schlüter-BARA-RTKE product line on page 260 of the PS 22 price list.

EDGE SUPPORT PROFILE | CORNER | CONNECTOR



Schlüter®-BARA-RTKEG



colour coated aluminium
profile length: 2.50 m, height: 4 mm, 10 mm, 15 mm, 18 mm, 21 mm
90° external corner, 135° external corner, 90° internal corner,
connectors in heights of 4 mm, 10 mm, 15 mm, 18 mm, 21 mm

Version	Art. No.	MyDesign surcharge
profile 2.50 m (4–21 mm)	C / RTKEG ...* A	B
90° external corner (4–21 mm)	C / E90 / RTKEG ...* A	B
135° external corner (4–21 mm)	C / E135 / RTKEG ...* A	B
90° internal corner (4–21 mm)	C / I90 / RTKEG ...* A	B
connector (4–21 mm)	C / V / RTKE ...* A	A

* To complete the art. no., add the height (e.g. C / RTKEG 4 A)

You can find the full Schlüter-BARA-RTKEG product line on page 261 of the PS 22 price list.

EDGE PROFILE | CORNER | CONNECTOR



Schlüter®-BARA-RAK



colour coated aluminium
profile length: 2.50 m
90° external corner, 135° external corner, 90° internal corner, connectors

Version	Art. No.	MyDesign surcharge
profile 2.50 m	C / RAK 50 A	B
90° external corner	C / E90 / RAK 50 A	B
135° external corner	C / E135 / RAK 50 A	B
90° internal corner	C / I90 / RAK 50 A	B
connector	C / V / RT 30 A	A

You can find the full Schlüter-BARA-RAK product line on page 262 of the PS 22 price list.

EDGE PROFILE | CORNER | CONNECTOR



Schlüter®-BARA-RAKE

colour coated aluminium
 profile length: 2.50 m, height: 10 mm, 15 mm, 18 mm, 21 mm
 90° external corner, 135° external corner, 90° internal corner,
 connectors in heights of 10 mm, 15 mm, 18 mm, 21 mm

Version	Art. No.	MyDesign surcharge
profile 2.50 m (10–21 mm)	C / RAKE ...* A	B
90° external corner (10–21 mm)	C / E90 / RAKE ...* A	B
135° external corner (10–21 mm)	C / E135 / RAKE ...* A	B
90° internal corner (10–21 mm)	C / I90 / RAKE ...* A	B
connector (10–21 mm)	C / V / RTKE ...* A	A

* To complete the art. no., add the height (e.g. C / RAKE 10 A)

You can find the full Schlüter-BARA-RAKE product line on page 263 of the PS 22 price list.

EDGE PROFILE | CORNER | CONNECTOR



Schlüter®-BARA-RAKEG

colour coated aluminium
 profile length: 2.50 m, height: 4 mm, 10 mm, 15 mm, 18 mm, 21 mm
 90° external corner, 135° external corner, 90° internal corner,
 connectors in heights of 4 mm, 10 mm, 15 mm, 18 mm, 21 mm

Version	Art. No.	MyDesign surcharge
profile 2.50 m (4–21 mm)	C / RAKEG ...* A	B
90° external corner (4–21 mm)	C / E90 / RAKEG ...* A	B
135° external corner (4–21 mm)	C / E135 / RAKEG ...* A	B
90° internal corner (4–21 mm)	C / I90 / RAKEG ...* A	B
connector (4–21 mm)	C / V / RTKE ...* A	A

* To complete the art. no., add the height (e.g. C / RAKEG 4 A)

You can find the full Schlüter-BARA-RAKEG product line on page 264 of the PS 22 price list.

EDGE PROFILE | CORNER | CONNECTOR



Schlüter®-BARA-RKK

colour coated aluminium
 profile length: 2.50 m, height: 10 mm, 15 mm, 18 mm
 90° external corner, 135° external corner, 90° internal corner, connectors in heights of 10 mm, 15 mm, 18 mm

Version	Art. No.	MyDesign surcharge
profile 2.50 m (10–18 mm)	C / RKK ...* A	B
90° external corner (10–18 mm)	C / E90 / RKK ...* A	B
135° external corner (10–18 mm)	C / E135 / RKK ...* A	B
90° internal corner (10–18 mm)	C / I90 / RKK ...* A	B
connector (10–18 mm)	C / V / RKK ...* A	A

* To complete the art. no., add the height (e.g. C / RKK 10 A)

You can find the full Schlüter-BARA-RKK product line on page 265 of the PS 22 price list.

EDGE PROFILE | CORNER | CONNECTOR

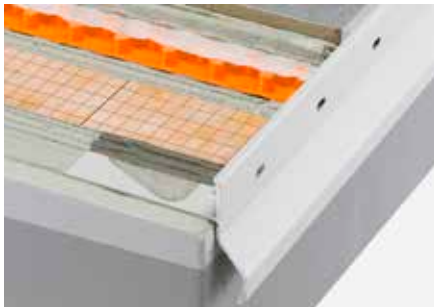

Schlüter®-BARA-RKKE



colour coated aluminium
profile length: 2.50 m, height: 8 mm, 10 mm, 15 mm, 18 mm, 21 mm, 23 mm
90° external corner, 135° external corner, 90° internal corner,
connectors in heights of 8 mm, 10 mm, 15 mm, 18 mm, 21 mm, 23 mm

Version	Art. No.	MyDesign surcharge
profile 2.50 m (8–23 mm)	C / RKKE ...* A	B
90° external corner (8–23 mm)	C / E90 / RKKE ...* A	B
135° external corner (8–23 mm)	C / E135 / RKKE ...* A	B
90° internal corner (8–23 mm)	C / I90 / RKKE ...* A	B
connector (8–23 mm)	C / V / RKK ...* A	A

* To complete the art. no., add the height (e.g. C / RKKE 8 A)

You can find the full Schlüter-BARA-RKKE product line on page 267 of the PS 22 price list.

EDGE PROFILE | CORNER | CONNECTOR



Schlüter®-BARA-RKB



colour coated aluminium
profile length: 2.50 m
90° external corner, 135° external corner, 90° internal corner, connectors

Version	Art. No.	MyDesign surcharge
profile 2.50 m	C / RKB 3 A	B
90° external corner	C / E90 / RKB 3 A	B
135° external corner	C / E135 / RKB 3 A	B
90° internal corner	C / I90 / RKB 3 A	B
connector	C / V / RKB 3 A	A

You can find the full Schlüter-BARA-RKB product line on page 268 of the PS 22 price list.

EDGE PROFILE | CORNER | CONNECTOR



Schlüter®-BARA-RK



colour coated aluminium
profile length: 2.50 m
90° external corner, 135° external corner, 90° internal corner, connectors

Version	Art. No.	MyDesign surcharge
profile 2.50 m	C / RK 65 A	B
90° external corner	C / E90 / RK 65 A	B
135° external corner	C / E135 / RK 65 A	B
90° internal corner	C / I90 / RK 65 A	B
connector	C / V / RK 65 A	A

You can find the full Schlüter-BARA-RK product line on page 270 of the PS 22 price list.

EDGE PROFILE | CORNER | CONNECTOR



Schlüter®-BARA-RKL



colour coated aluminium
 profile length: 2.50 m, height: 30 mm, 35 mm, 40 mm, 50 mm, 75 mm
 90° external corner, 135° external corner, 90° internal corner,
 connectors in heights of 30 mm, 35 mm, 40 mm, 50 mm, 75 mm

Version	Art. No.	MyDesign surcharge
profile 2.50 m (30–75 mm)	C / RKL ...* A	B
90° external corner (30–75 mm)	C / E90 / RKL ...* A	B
135° external corner (30–75 mm)	C / E135 / RKL ...* A	B
90° internal corner (30–75 mm)	C / I90 / RKL ...* A	B
connector (30–75 mm)	C / V / RKL ...* A	A

* To complete the art. no., add the height (e.g. C / RKL 30 A)

You can find the full Schlüter-BARA-RKL product line on pages 272-273 of the PS 22 price list.

EDGE SUPPORT PROFILE | CORNER | CONNECTOR



Schlüter®-BARA-RKLT



colour coated aluminium
 profile length: 2.50 m, height: 30 mm, 40 mm, 50 mm, 75 mm
 90° external corner, 135° external corner, 90° internal corner,
 connectors in heights of 30 mm, 40 mm, 50 mm, 75 mm

Version	Art. No.	MyDesign surcharge
profile 2.50 m (30–75 mm)	C / RKLT ...* A	B
90° external corner (30–75 mm)	C / E90 / RKLT ...* A	B
135° external corner (30–75 mm)	C / E135 / RKLT ...* A	B
90° internal corner (30–75 mm)	C / I90 / RKLT ...* A	B
connector (30–75 mm)	C / V / RKLT ...* A	A

* To complete the art. no., add the height (e.g. C / RKLT 30 A)

You can find the full Schlüter-BARA-RKLT product line on page 275 of the PS 22 price list.



Schlüter®-KERDI-LINE-VARIO

Drainage has never been more adaptable

Our adaptable system for linear drainage in level entry showers. The stylish drainage profiles which can easily be cut to precisely match your requirement are connected to a slim drain body. The integrated elasticated KERDI collar provides a waterproof seal between the drain and the adjacent substrate. The 360 degree rotatable drain offers optimum flexibility during installation.

- ✓ Slim drainage profiles blending unobtrusively with the tile covering
- ✓ High-quality materials: brushed stainless steel or TRENDLINE powder coated aluminium
- ✓ Drainage profiles (120 cm or 180 cm), can be individually cut to size, height-adjustable
- ✓ Matching end caps included with the drainage profiles
- ✓ Low assembly height
- ✓ Integrated odour trap
- ✓ Secure waterproofing connection with elasticated KERDI collar
- ✓ Self-cleaning drain body, rotatable by 360 degrees
- ✓ Sound insulation element
- ✓ High drain capacity
- ✓ Proven KERDI-LINE quality



The Schlüter-KERDI-LINE-VARIO drain profile directs the waste water into a slim wave shaped drain body with an elasticated waterproofing collar. The combination of drain adapter with integrated elasticated waterproofing collar and wave shaped drain channels the waste water horizontally into the on-site drainage system. A screeded tiled shower floor with a 2% gradient should be provided to allow water to run into the drainage profile.

Schlüter-DECO-SG keeps shower screens in their correct positions. Schlüter-KERDI and -DITRA ensure waterproofing in the wall and floor area. Abutting joints are sealed with Schlüter-KERDI-KEBA sealing bands, using Schlüter-KERDI-COLL-L.

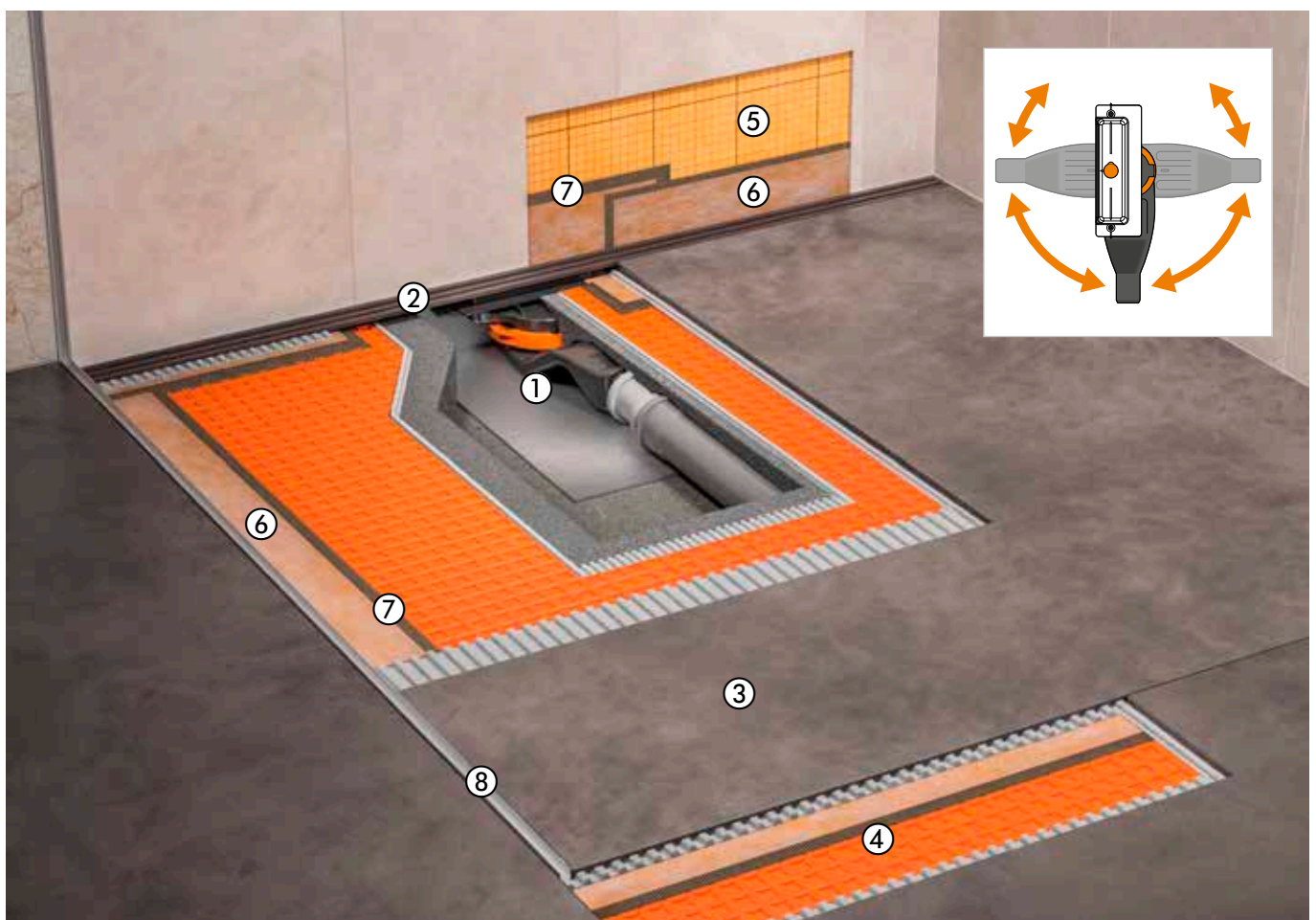

- | | |
|--|----------|
| ① Schlüter®-KERDI-LINE-VARIO-H wave-shaped drain | Page 162 |
| ② Schlüter®-KERDI-LINE-VARIO drainage profile | Page 160 |
| ③ Sloped screed | – |
| ④ Schlüter®-DITRA | Page 132 |
| ⑤ Schlüter®-KERDI 200 | Page 148 |
| ⑥ Schlüter®-KERDI-KEBA | Page 149 |
| ⑦ Schlüter®-KERDI-COLL-L | Page 154 |
| ⑧ Schlüter®-DECO-SG | Page 188 |

Note:

The page numbers listed refer to price list PS 22.



DRAINAGE PROFILE

Schlüter®-KERDI-LINE-VARIO WAVE



Schlüter-KERDI-LINE-VARIO WAVE is a W shaped drainage profile, which can be cut to size, for use with a Schlüter-KERDI-LINE-VARIO-H body. It is available in either brushed stainless steel V4A (material no. 1.4404 = AISI 316L) or one of eight TRENDLINE powder coated aluminium finishes. A 140 mm opening allows water to flow into the drain. The opening is concealed by a removable cover panel. The drainage profile is supplied with two matching end caps. The installation height can be adjusted to the thickness of the floor covering by use of tile adhesive. (Product data sheet 8.10)

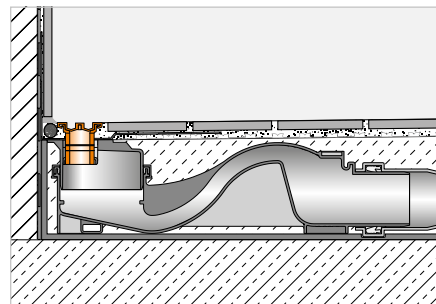

i
Available from November 2022

Schlüter®-KERDI-LINE-VARIO WAVE 34

drainage profile, WAVE design (D 10), textured aluminium

L (cm)	H = 8 mm Art. No.	£ / Set	P (Set)
120	KL VR D10 MBW 120	177.44	10
120	KL VR D10 MGS 120	177.44	10
120	KL VR D10 TSBG 120	182.81	10
120	KL VR D10 TSC 120	182.81	10
120	KL VR D10 TSDA 120	182.81	10
120	KL VR D10 TSI 120	182.81	10
120	KL VR D10 TSOB 120	182.81	10
120	KL VR D10 TSSG 120	182.81	10
★ 180	KL VR D10 MBW 180	198.88	10
★ 180	KL VR D10 MGS 180	198.88	10
★ 180	KL VR D10 TSBG 180	203.50	10
★ 180	KL VR D10 TSC 180	203.50	10
★ 180	KL VR D10 TSDA 180	203.50	10
★ 180	KL VR D10 TSI 180	203.50	10
★ 180	KL VR D10 TSOB 180	203.50	10
★ 180	KL VR D10 TSSG 180	203.50	10

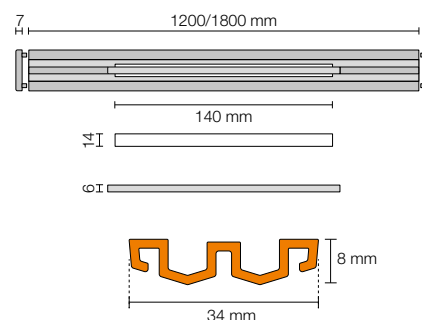

Suitable for covering thicknesses of 6–15 mm (with DITRA or DITRA-HEAT) and 6–12 mm (with DITRA-HEAT-DUO).

In conjunction with the frame extension KL VR DSE 14, suitable for covering thicknesses up to 25 mm (with DITRA or DITRA-HEAT) and up to 22 mm (with DITRA-HEAT-DUO); see page 17.

Schlüter®-KERDI-LINE-VARIO WAVE 42

drainage profile, WAVE design (D 10), brushed stainless steel V4A

L (cm)	H = 10 mm Art. No.	£ / Set	P (Set)
120	KL VR1 D10 EB 120	263.63	10
180	KL VR1 D10 EB 180	296.00	10

Suitable for covering thicknesses of 8–18 mm (with DITRA or DITRA-HEAT) and 8–15 mm (with DITRA-HEAT-DUO).

In conjunction with the frame extension KL VR DSE 23, suitable for covering thicknesses up to 28 mm (with DITRA or DITRA-HEAT) and up to 25 mm (with DITRA-HEAT-DUO); see page 17.

The KERDI-LINE WAVE 42 profile in the stainless steel version supports the use of wheelchairs in showers.

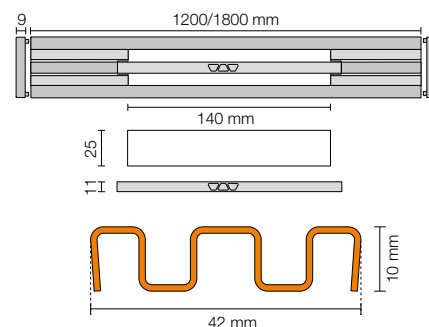
**Schlüter®-KERDI-LINE-VARIO WAVE 42**

drainage profile, WAVE design (D 10), textured aluminium

L (cm)	H = 8 mm Art. No.	£ / Set	P (Set)
120	KL VR1 D10 MBW 120	185.00	10
120	KL VR1 D10 MGS 120	185.00	10
120	KL VR1 D10 TSBG 120	189.63	10
120	KL VR1 D10 TSC 120	189.63	10
120	KL VR1 D10 TSDA 120	189.63	10
120	KL VR1 D10 TSI 120	189.63	10
120	KL VR1 D10 TSOB 120	189.63	10
120	KL VR1 D10 TSSG 120	189.63	10
180	KL VR1 D10 MBW 180	208.13	10
180	KL VR1 D10 MGS 180	208.13	10
180	KL VR1 D10 TSBG 180	212.75	10
180	KL VR1 D10 TSC 180	212.75	10
180	KL VR1 D10 TSDA 180	212.75	10
180	KL VR1 D10 TSI 180	212.75	10
180	KL VR1 D10 TSOB 180	212.75	10
180	KL VR1 D10 TSSG 180	212.75	10

Suitable for covering thicknesses of 6–15 mm (with DITRA or DITRA-HEAT) and 6–12 mm (with DITRA-HEAT-DUO).

In conjunction with the frame extension KL VR DSE 23, suitable for covering thicknesses up to 25 mm (with DITRA or DITRA-HEAT) and up to 22 mm (with DITRA-HEAT-DUO); see page 17.

The profiles KERDI-LINE-VARIO WAVE 42 profiles can be fitted with an optional hair trap KL VR S 23; see page 17.

Note:

The drainage profiles of the Schlüter-KERDI-LINE-VARIO series can only be combined with the Schlüter-KERDI-LINE-VARIO-H drain bodies.

Two end caps are included in the set.

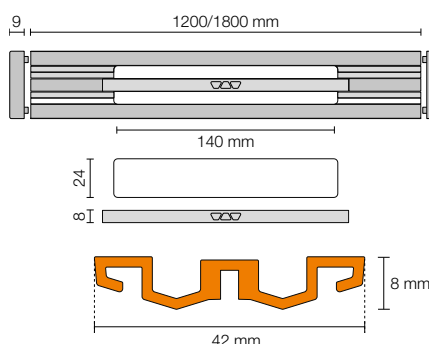
**AVAILABLE FINISHES | COLOURS**

For an overview of finishes and colours, please see PS 22 from page 293.



DRAINAGE PROFILE

Schlüter®-KERDI-LINE-VARIO COVE



Schlüter-KERDI-LINE-VARIO COVE is a cove-shaped drainage profile, which can be cut to size, for use with a Schlüter-KERDI-LINE-VARIO-H body. It is available in either brushed stainless steel V4A (material no. 1.4404 = AISI 316L) or one of eight TRENDLINE powder coated aluminium finishes. An opening 8 mm wide and 140 mm long allows water to flow into the drain. The drainage profile is supplied with two matching end caps. The installation height can be adjusted to the thickness of the floor covering by use of tile adhesive. This profile supports the use of wheelchairs in showers.

(Product data sheet 8.10)

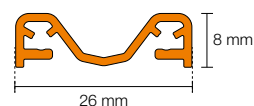
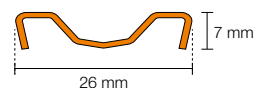
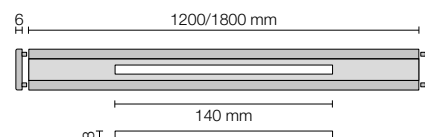
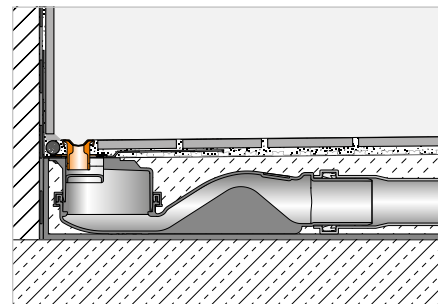

Schlüter®-KERDI-LINE-VARIO COVE 26

drainage profile, COVE design (D 9), brushed stainless steel V4A

L (cm)	H = 7 mm Art. No.	£ / Set	P (Set)
120	KL VR D9 EB 120	210.14	10
★ 180	KL VR D9 EB 180	245.13	10

Schlüter®-KERDI-LINE-VARIO COVE 26

drainage profile, COVE design (D 9), textured aluminium

L (cm)	H = 8 mm Art. No.	£ / Set	P (Set)
120	KL VR D9 MBW 120	155.93	10
120	KL VR D9 MGS 120	155.93	10
120	KL VR D9 TSBG 120	161.30	10
120	KL VR D9 TSC 120	161.30	10
120	KL VR D9 TSDA 120	161.30	10
120	KL VR D9 TSI 120	161.30	10
120	KL VR D9 TSOB 120	161.30	10
120	KL VR D9 TSSG 120	161.30	10
★ 180	KL VR D9 MBW 180	175.75	10
★ 180	KL VR D9 MGS 180	175.75	10
★ 180	KL VR D9 TSBG 180	180.38	10
★ 180	KL VR D9 TSC 180	180.38	10
★ 180	KL VR D9 TSDA 180	180.38	10
★ 180	KL VR D9 TSI 180	180.83	10
★ 180	KL VR D9 TSOB 180	180.38	10
★ 180	KL VR D9 TSSG 180	180.38	10

Note:

The drainage profiles of the Schlüter-KERDI-LINE-VARIO series can only be combined with the Schlüter-KERDI-LINE-VARIO-H drain bodies.

Two end caps are included in the set.

Suitable for covering thicknesses of 6–15 mm (with DITRA or DITRA-HEAT) and 6–12 mm (with DITRA-HEAT-DUO).

In conjunction with the frame extension KL VR DSE 14, suitable for covering thicknesses up to 25 mm (with DITRA or DITRA-HEAT) and up to 22 mm (with DITRA-HEAT-DUO); see page 17.

AVAILABLE FINISHES | COLOURS



For an overview of finishes and colours, please see PS 22 from page 293.

EXTENSION

Schlüter®-KERDI-LINE-VARIO-DSE



KL VR DSE 14

Schlüter-KERDI-LINE-VARIO-DSE is a frame extension set that enables the use of the corresponding drainage profiles with coverings that are 10 mm thicker than that usually allowed with Schlüter-KERDI-LINE-VARIO WAVE or Schlüter-KERDI-LINE-VARIO COVE drainage profiles.

(Product data sheet 8.10)



KL VR DSE 23

Schlüter®-KERDI-LINE-VARIO-DSE ★

extension for KERDI-LINE-VARIO

Art. No.	£ / U.	P (Unit)
KL VR DSE 14	14.34	10

Available from November 2022

Schlüter®-KERDI-LINE-VARIO-DSE ★

extension for KERDI-LINE-VARIO

Art. No.	£ / Set	P (Set)
KL VR DSE 23	16.65	10

HAIR TRAP

Schlüter®-KERDI-LINE-VARIO-S



Schlüter-KERDI-LINE-VARIO-S is an optionally available hair trap for the WAVE 42 profile series, which in addition to its primary function also reliably prevents small parts such as jewellery from being flushed down the drain.

(Product data sheet 8.10)

Available from November 2022

Schlüter®-KERDI-LINE-VARIO-S ★

hair trap for KERDI-LINE-VARIO WAVE 42

Art. No.	£ / U.	P (Unit)
KL VR S 23	13.88	10



LINEAR DRAINAGE, HORIZONTAL

Schlüter®-KERDI-LINE-VARIO-H 40



Schlüter-KERDI-LINE-VARIO-H 40 is a complete set for linear floor-level showers. It comprises a drain adapter with an integrated elasticated KERDI waterproofing collar. To enable an especially low assembly height, the waterproof adapter comes fully inserted into the sealed wave shaped drain. The adapter is additionally secured with a clamping ring. KERDI-LINE-VARIO-H 40 is suited for installation in an intermediate position and especially along walls. The high flow rate in the drain body results in a self-cleaning effect. The sound insulation element included in the set reliably prevents sound transmission to the surrounding building structures and serves as a positioning aid for direct installation in a wall. (Product data sheet 8.10)

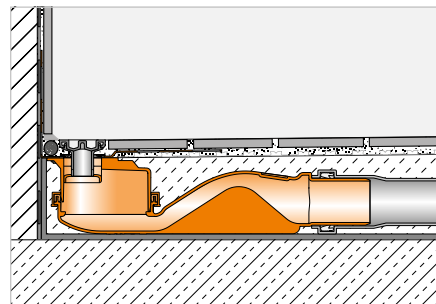

i
Available from November 2022

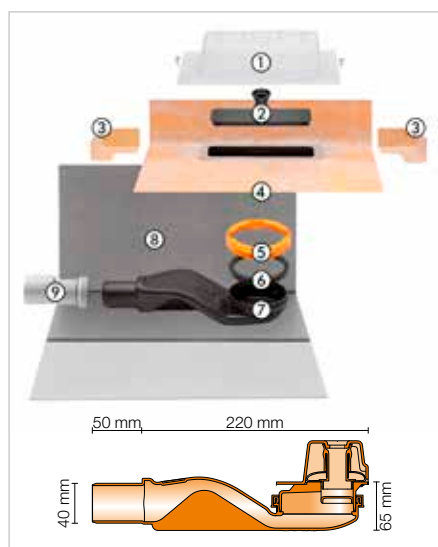

Set components:

- 1 protective lid
- 2 water inspection nozzle
- 3 corner seal
(for upright wall connection)
- 4 drainage profile connector with elasticated waterproofing collar
- 5 clamping ring
- 6 gasket
- 7 drain body DN 40 with odour trap
- 8 sound insulation element
- 9 adapter DN 40/50

Schlüter®-KERDI-LINE-VARIO-H 40

linear wave shaped drain set with DN 40 horizontal outlet

Art. No.	£ / Set	P (Set)
KL VR H40 G5	194.25	10

Note:

The drain is only suitable for use with Schlüter-KERDI-LINE-VARIO drainage profiles.

Technical data:

Drain	DN 40
Drain capacity	*
Water trap height	25 mm
Installation height	65 mm

* Drain capacity varies depending on the chosen profile.

COVE 26: 0.45 l/s

WAVE 34: 0.45 l/s

WAVE 42: 0.5 l/s

LINEAR DRAINAGE, HORIZONTAL

Schlüter®-KERDI-LINE-VARIO-H 50



Schlüter-KERDI-LINE-VARIO-H 50 is a complete set for linear floor-level showers. It comprises a drain adapter with an integrated elasticated KERDI waterproofing collar that can be cut to size to meet on-site height requirements as well as a horizontal drain with integrated odour trap that can be rotated by 360 degrees. The drain can be attached to the floor with the supplied installation set. KERDI-LINE-VARIO-H 50 is suited for installation in an intermediate position and especially along walls. The high flow rate in the drain body results in a self-cleaning effect. The sound insulation element included in the set reliably prevents sound transmission to the surrounding building structures and serves as a positioning aid for direct installation in a wall. (Product data sheet 8.10)

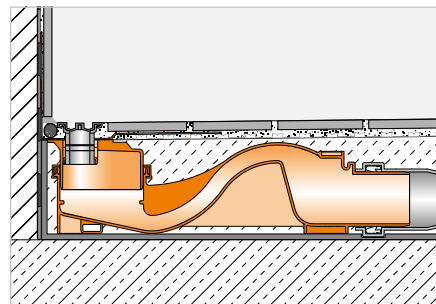

Available from November 2022

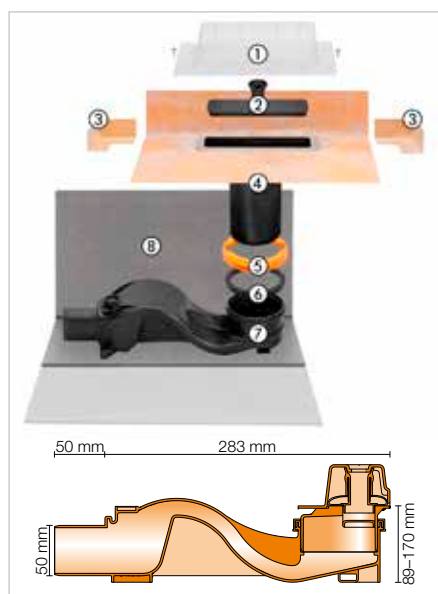

Set components:

- 1 protective lid
- 2 water inspection nozzle
- 3 corner seal
(for upright wall connection)
- 4 drainage profile connector, can be cut to size, with elasticated waterproofing collar
- 5 clamping ring
- 6 gasket
- 7 drain body DN 50 with odour trap
- 8 sound insulation element

Schlüter®-KERDI-LINE-VARIO-H 50

linear wave shaped drain set with DN 50 horizontal outlet

Art. No.	£ / Set	P (Set)
KL VR H50 A G5	208.13	10

Note:

The drain is only suitable for use with Schlüter-KERDI-LINE-VARIO drainage profiles.

Technical data:

Drain	DN 50
Drain capacity	*
Water trap height	50 mm
Installation height	89 mm

* Drain capacity varies depending on the chosen profile.

COVE 26: 0.7 l/s

WAVE 34: 0.7 l/s

WAVE 42 (aluminium): 0.7 l/s

WAVE 42 (EB): 0.8 l/s



ATTACHMENT PROFILE

Schlüter®-DECO-SG



Schlüter-DECO-SG is a decorative profile for joint design in tile coverings. It forms either a 12 mm or 15 mm wide shadow gap. The profile is ideal for holding and fixing glass elements in the floor and wall area.
(Product data sheet 2.16)

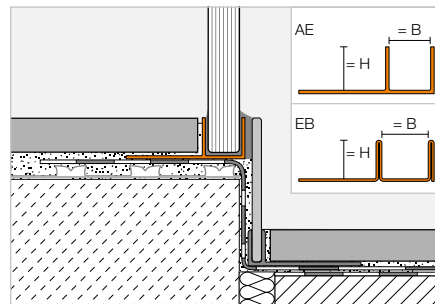

Schlüter®-DECO-SG-EB

brushed stainless steel V4A, B = 12 mm

H (mm)	L = 2.50 m Art. No.	£ / m	KV (Unit)
8	SG 80 EB 12	44.19	120
10	SG 100 EB 12	46.41	120
11	SG 110 EB 12	48.62	120
12.5	SG 125 EB 12	50.82	120

Schlüter®-DECO-SG-EB

brushed stainless steel V4A, B = 15 mm

H (mm)	L = 2.50 m Art. No.	£ / m	KV (Unit)
8	SG 80 EB 15	47.50	120
10	SG 100 EB 15	49.71	120
11	SG 110 EB 15	51.92	120
12.5	SG 125 EB 15	54.14	120

Schlüter®-DECO-SG-AE

anodised aluminium, B = 12 mm

H (mm)	L = 2.50 m Art. No.	£ / m	KV (Unit)
8	SG 80 AE 12	15.88	120
10	SG 100 AE 12	16.33	120
11	SG 110 AE 12	16.71	120
12.5	SG 125 AE 12	17.11	120

Schlüter®-DECO-SG-AE

anodised aluminium, B = 15 mm

H (mm)	L = 2.50 m Art. No.	£ / m	KV (Unit)
8	SG 80 AE 15	18.25	120
10	SG 100 AE 15	18.53	120
11	SG 110 AE 15	19.18	120
12.5	SG 125 AE 15	19.61	120

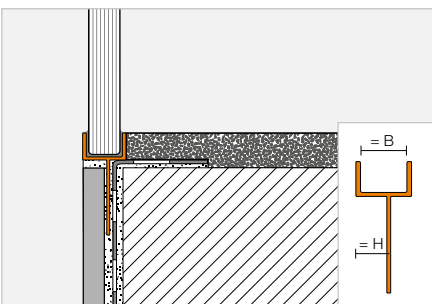

i
For use in corners with
adjoining plaster walls

Schlüter®-DECO-SGC-AE ★

anodised aluminium, B = 12 mm

H (mm)	L = 2.50 m Art. No.	£ / m	KV (Unit)
8	SGC 80 AE 12	17.05	120
10	SGC 100 AE 12	17.45	120
11	SGC 110 AE 12	17.90	120
12.5	SGC 125 AE 12	18.35	120

Schlüter®-DECO-SGC-AE ★

anodised aluminium, B = 15 mm

H (mm)	L = 2.50 m Art. No.	£ / m	KV (Unit)
8	SGC 80 AE 15	19.74	120
10	SGC 100 AE 15	19.98	120
11	SGC 110 AE 15	20.68	120
12.5	SGC 125 AE 15	21.13	120



Schlüter®-DITRA

The original. Now even better.

The DITRA membrane with its functional versatility has been a proven universal substrate for tile assemblies all over the world. Now DITRA has a new geometry to make it even easier to install. All benefits at a glance:

- ✓ **Quick, dependable and easy to install**
- ✓ **EasyCut imprinted gridlines – Quick and easy custom cuts**
- ✓ **EasyFill design – Easier application of tile adhesive with integrated air release vents**
- ✓ **Modified undercutting for improved tile adhesive bonding**
- ✓ **Easy roll-out characteristics**
- ✓ **Proven functions:**
 - Waterproofing
 - Uncoupling and crack bridging
 - Vapour pressure equalisation
 - Load transfer
 - Heat distribution





BONDED UNCOUPLING

Schlüter®-DITRA

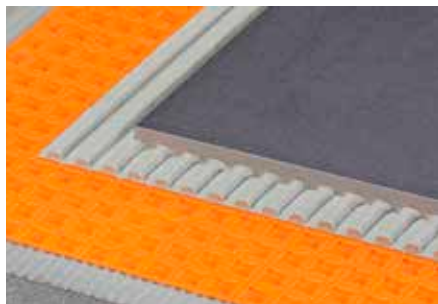

Schlüter-DITRA is a polypropylene membrane with square, dovetailed EasyFill recesses and an anchoring fleece laminated to the underside. In conjunction with tiled coverings, Schlüter-DITRA forms an uncoupling, waterproofing and vapour pressure equalisation layer.

(Product data sheet 6.1)

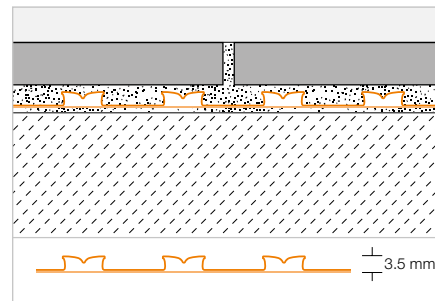

Schlüter®-DITRA



polypropylene rolls

L x B = m ²	Art. No.	£ / m ²	PL (Roll)
30.2 x 0.995 = 30	D 30M	17.63	6
5.1 x 0.995 = 5	D 5M	21.24	22

Tool tip:

Schlüter-TROWEL, 4 x 4 notching,
see PS 22, page 291.



General Terms and Conditions



You find the actual “General Terms and Conditions” of Schlüter-Systems Ltd. here:
www.schluter.co.uk/downloads.aspx

Key

Properties



also available in 3 m



EasyCut gridlines



Radius perforation available



EasyFill design

Innovations



New product

Packaging units

PL = euro pallet

KV = case packaging

BV = bundle

All profiles are packaged in bundles of 10, unless specifically noted otherwise.

P = box packaging

R = roll

Unit = units

Dimensions

H = height

L = length

B = width

T = depth

Technical developments may lead to changes from the images, drawings and descriptions.



www.schluter-systems.com



Subject to the Standard Terms and Conditions of Sale of Schlüter-Systems Ltd.
Errors, changes, and printing mistakes as well as changes necessary in the interest of product innovation or shipping reserved. For reasons of printing, colours shown in this price list may differ from actual product colours.



P R O F I L E O F I N N O V A T I O N

Schlüter-Systems KG · Schmölestraße 7 · D-58640 Iserlohn

Tel.: +49 2371 971-261 · Fax: +49 2371 971-112 · info@schlueter.de · www.schluter-systems.com

Schlüter-Systems Ltd · Units 3-5 Bardon 22 Industrial Estate · Beveridge Lane · Coalville · Leicestershire · LE67 1TE

Tel.: +44 1530 813396 · Fax: +44 1530 813376 · sales@schluter.co.uk · www.schluter.co.uk